



4/16 Ewos Parade Cronulla NSW

1 1 1

Located in highly sought after South Cronulla, this one bedroom apartment is just seconds to beach and has direct access to The Esplanade.

- Small block of only six apartments
- Spacious apartment measuring 55.7m2approx.
- Direct walking access to The Esplanade
- Modern kitchen and original bathroom
- Shared laundry at the rear of the block
- Single allocated car space
- Good sized balcony for afternoon bbq's
- Close to everything Cronulla has to offer

Please register for inspections via 'email agent' button. Otherwise we unfortunately aren't able to notify you of any inspection changes.

Building Size : 55.7 sqm
View : <https://www.cronullarealestate.com.au/lease/nsw/sutherland/cronulla/residential/apartment/7160449>



Property Management Team
02 9523 9422

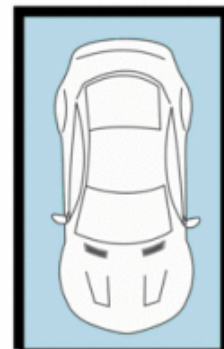
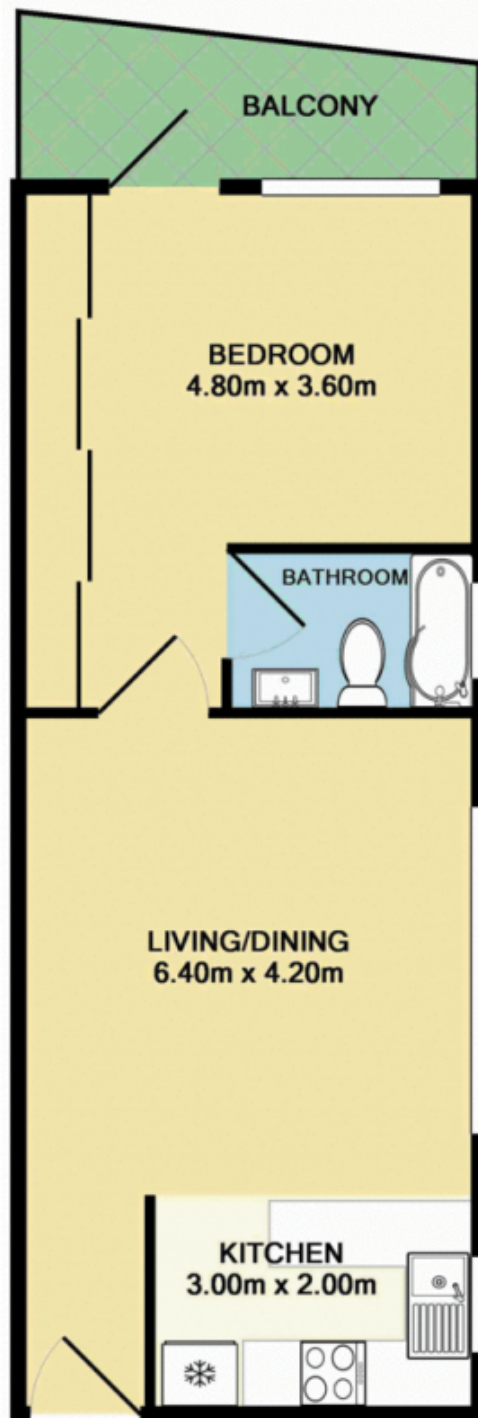

Car Space