



### 1 North East Crescent Lilli Pilli NSW

4 3 3

Situated in a tranquil neighbourhood and conveniently located within close proximity to parks, local schools & shops, this contemporary brick, dual level family home is simply perfect for the growing family. Featuring multiple indoor living and dining areas along with a very versatile & spacious design. Enjoy the privacy of low maintenance outdoor entertaining by the pool, terrace and BBQ area.

- Multiple formal and informal living and dining areas throughout the home
- Large entertainer's kitchen with stone island bench top & quality appliances
- Kitchen/dining flows seamlessly to pool & outdoor area ideal for family living
- Huge formal living room, separate media room, plus home office downstairs
- Four spacious bedrooms upstairs with separate living &

**Price** : \$ 2,850,000  
**Land Size** : 654 sqm  
**View** : <https://www.cronullarealestate.com.au/sale/nsw/sutherland/lilli-pilli/residential/house/6598148>

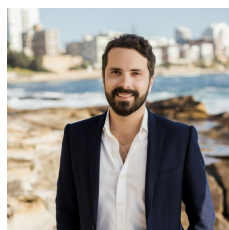

**Corey Bell**  
02 9523 9422



**Adrianna May**  
02 9523 9422

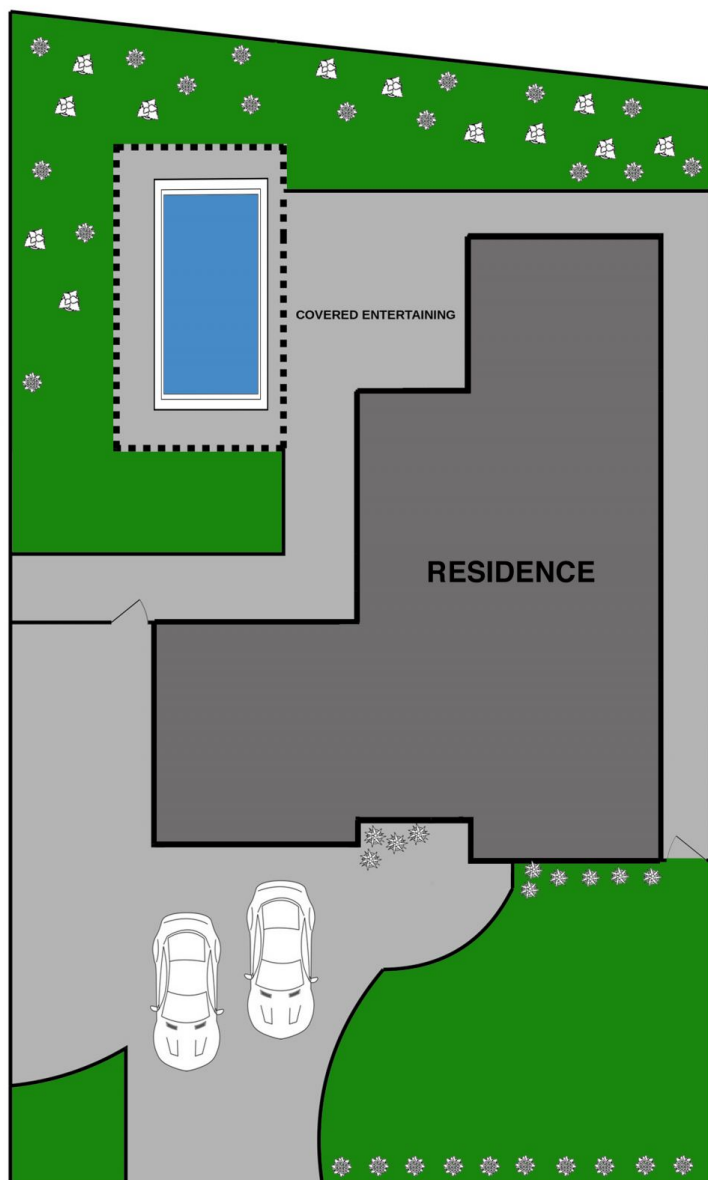

Siteplan (not to scale)

