



**13 Trevellyan Street Cronulla NSW**

5 3 2

This generous family home delivers a very versatile floor plan of impressive proportions located in a sought after South Cronulla position, consistently coveted for its proximity to stunning beaches, parks & school.

You will be captured by the functionality of this home, designed with a great blend of generous formal & informal living & dining spaces. Presenting comfortable living for the largest of families. High raked ceilings give a wonderful feeling of space, whilst the north facing orientation at the rear of the home allows for plenty of natural light to flow throughout.

A truly appealing family home in one of the best lifestyle locations in Cronulla.

-Impressive north facing, double storey, brick family home.

**Building Size** : 594.4 sqm  
**View** : <https://www.cronullarealestate.com.au/sale/nsw/sutherland/cronulla/residential/house/6283270>



**Mark Wigley**  
02 9523 9422



**Adrianna May**  
02 9523 9422

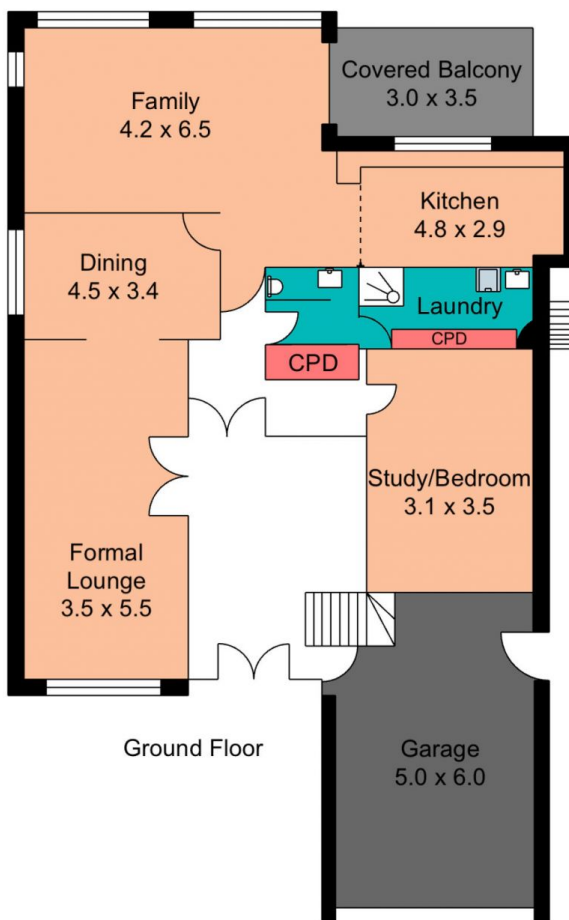
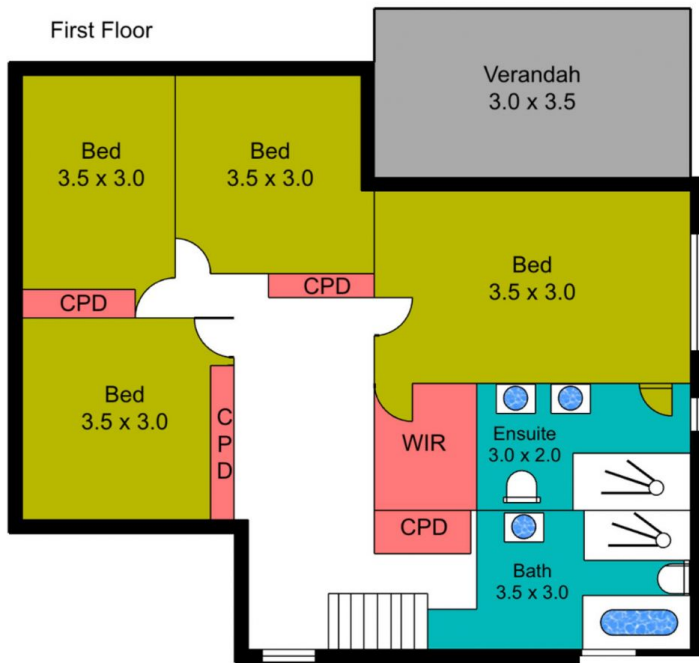

Site Plan

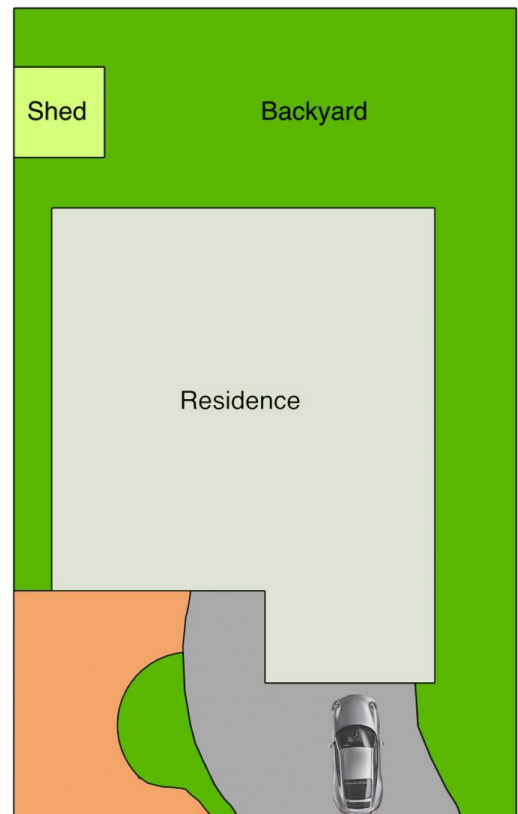

**DISCLAIMER: PLANS SHOWN ARE FOR PRESENTATION PURPOSES AND ARE NOT PART OF ANY LEGAL DOCUMENT. ALL MEASUREMENTS AND FIGURES ARE APPROXIMATE.**