



14a Dolans Road Woollooware NSW

3 3 2

A stunning design showcasing sophisticated style, providing the perfect sanctuary for young families and downsizers. Created by Jamisa Architects, this elegant residence exudes a relaxed coastal vibe and wrapped by beautiful lush gardens and level lawns. Featuring the best of indoor/outdoor living, desired North/East aspect and walking distance to local schools, transport, and Cronulla's beaches & shops.

Land Size : 391 sqm
View : <https://www.cronullarealestate.com.au/sale/nsw/sutherland/woollooware/residential/semi-detached/5768035>

- Striking entry with high ceilings, polished tile throughout and light filled interiors.
- Designer kitchen with gas cooking, dual ovens, island bench & integrated Vintec Beer & Wine fridge.
- Spacious open plan living/dining, plus study and extra optional media room/fourth bedroom.
- Entertaining options with sundrenched deck flowing to low maintenance north facing yard, plus an extra north facing



Mark Wigley
02 9523 9422



Adrianna May
02 9523 9422



Ground Floor

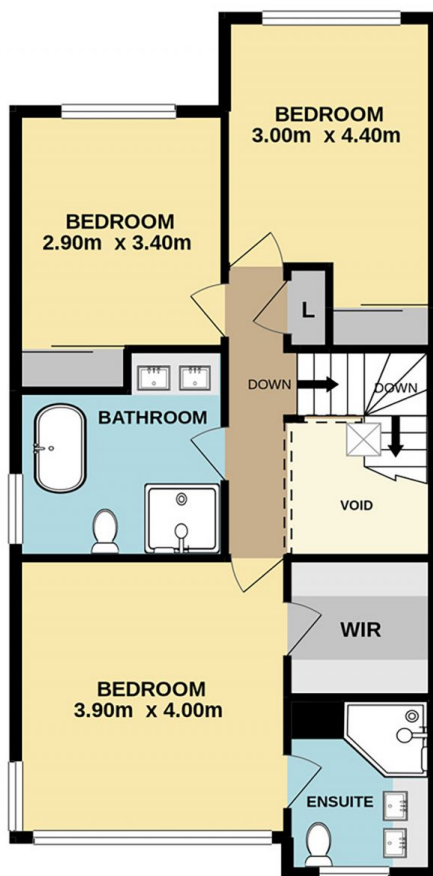

First Floor



Siteplan (not to scale)



14a Dolans Road Woolooware

DISCLAIMER: PLANS SHOWN ARE FOR PRESENTATION PURPOSES AND ARE NOT PART OF ANY LEGAL DOCUMENT. ALL MEASUREMENTS AND FIGURES ARE APPROXIMATE.