



68A Cawarra Road CARINGBAH NSW

4  3  2 

This North-East facing architecturally designed home has been impeccably created to provide light-filled interiors and seamless indoor and outdoor living, perfect for entertaining all year round.

Open Plan living enhanced by exposed vaulted ceilings and natural sunlight.

Stunning kitchen, CaesarStone benchtops, stainless steel appliances & gas cooking.

Retractable bi-fold doors flow seamlessly to alfresco area and sparkling saltwater plunge pool.

Oversized master bedroom with luxury size ensuite with His & Hers walk in robes.

All additional bedrooms are queen size and equipped with built-in robes.

Ground floor bedroom or media room, plus additional home office.

Bathrooms all complete with luxury finishes and

View : <https://www.cronullarealestate.com.au/sale/nsw/sutherland/caringbah/residential/semi-detached/5721590>



Mark Wigley
02 9523 9422



Adrianna May
02 9523 9422

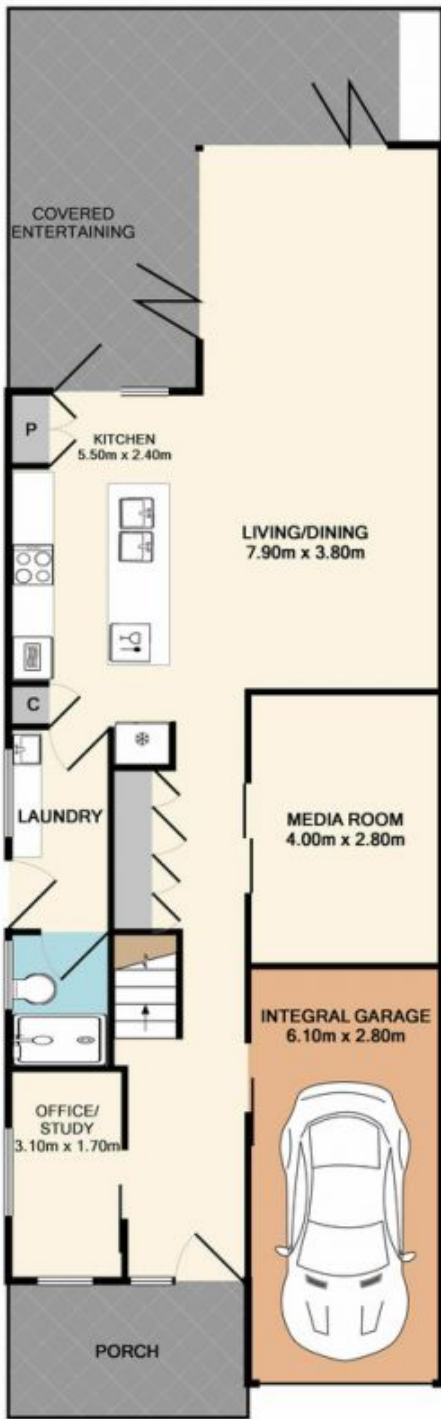

Ground Floor

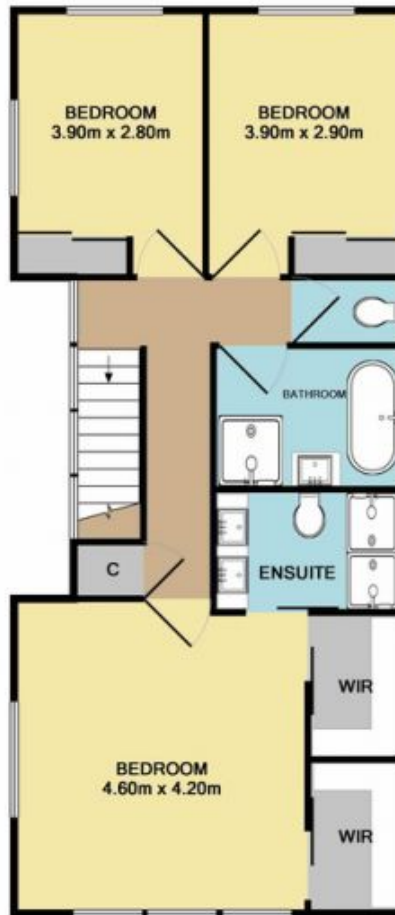

1st Floor

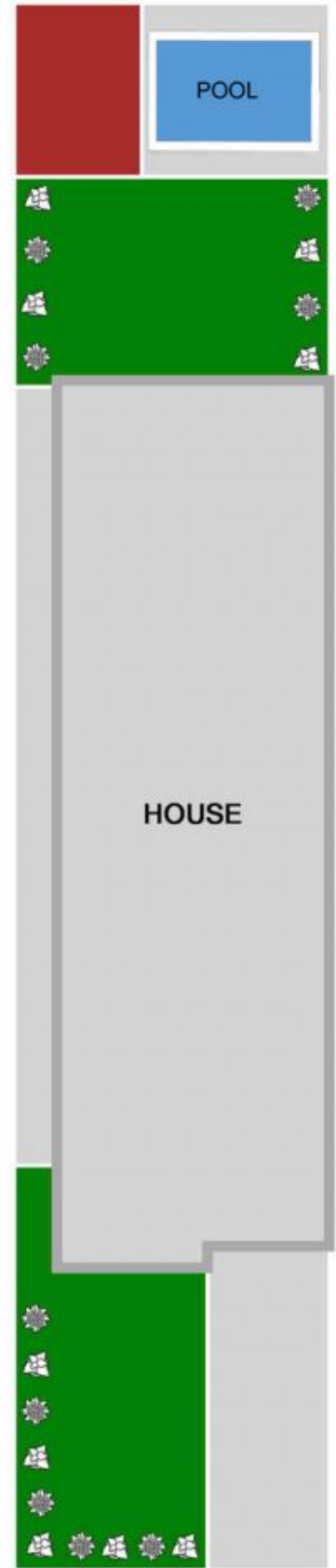

Site Plan (not to scale)



68a Cawarra Road Caringbah

DISCLAIMER: PLANS SHOWN ARE FOR PRESENTATION PURPOSES AND ARE NOT PART OF ANY LEGAL DOCUMENT. ALL MEASUREMENTS AND FIGURES ARE APPROXIMATE.